



Fitting Instructions for IFP– GRP

Integrated Fixing Point for GRP Roofing



Tel 0845 0098 980
Fax 0845 6588 980
Email info@nicholsonsts.com
Web www.nicholsonsts.com

integrated fixing point **ROOFTRAK™**

Use

The IFP-GRP fitting is designed to be integrated with GRP roofing systems. It is supplied pre coated with GRP resin containing 600 gsm CSM. The IFP-GRP can be fitted to vertical or horizontal surfaces to be weathered in GRP.

Setting out

Mark out positions of each IFP fixing plate prior to installing. Ensure that the M10 anchor points to the top surface of each fitting aligns with the structure or fixing holes in the rails that will be fitted to the IFP fittings.

Fixing

Taking into account the uplift forces that will be imposed on the fitting use appropriate fixings in all 8 no holes in the IFP-GRP. See Fig 1 below.

Weathering

The IFP-GRP should be weathered into the resin base coat on the surrounding roof area lapping the base coat onto the pre-coated areas. The GRP system manufacturers instructions should be adhered to. See Fig 2 below.

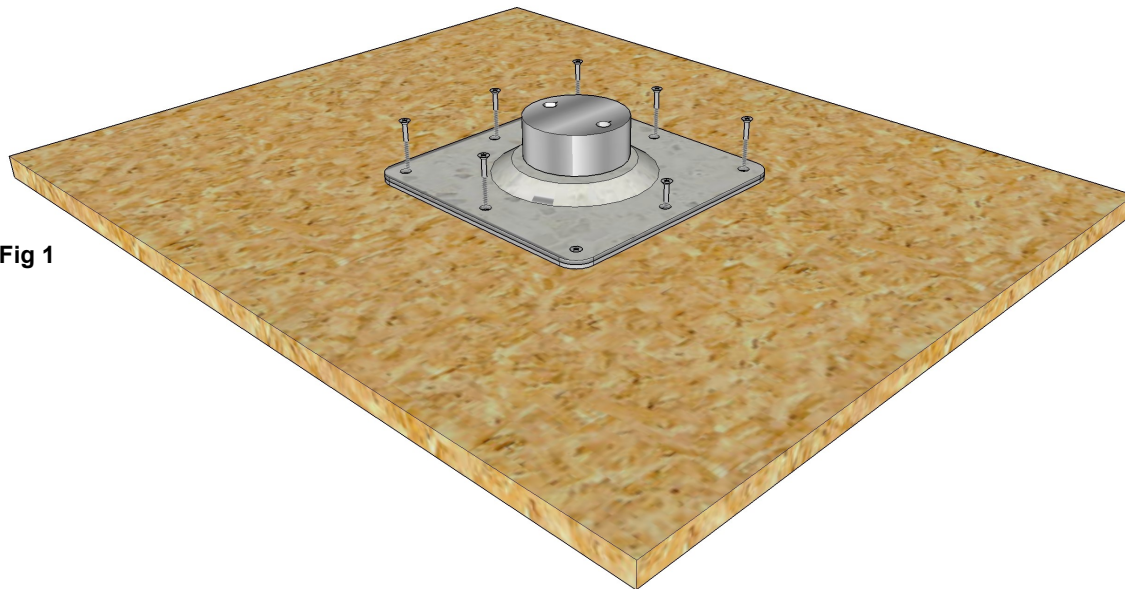

Fig 1

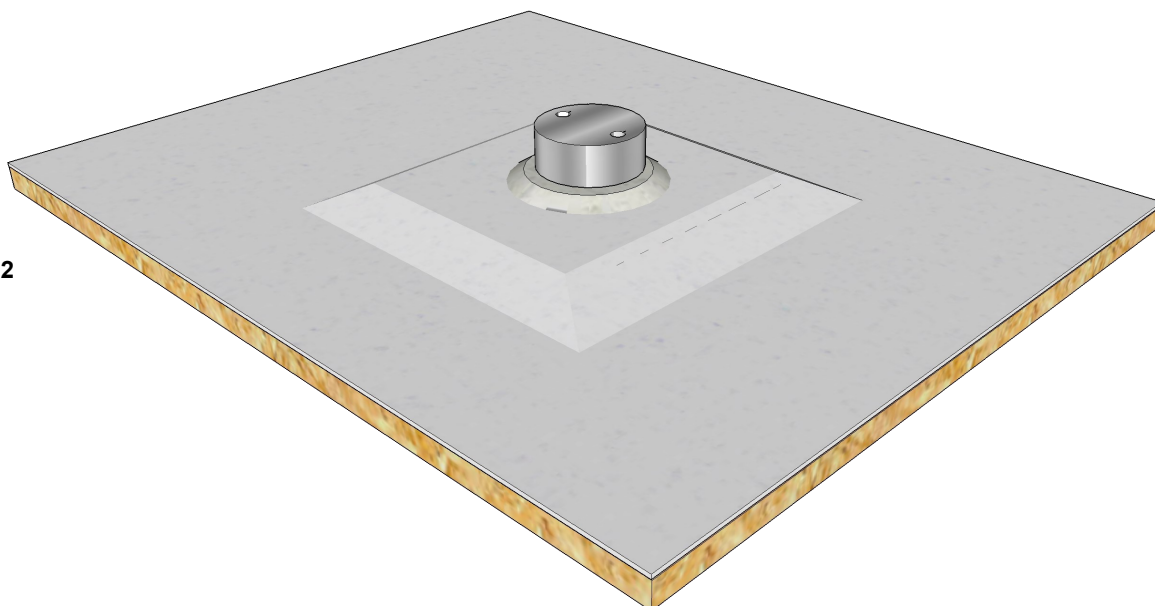

Fig 2

integrated fixing point ROOFTRAK™

Weathering continued

When the top coat of the GRP system is applied to the IFP-GRP and surrounding area, masking should be applied to the sides of the stainless steel fixing point. **Note** take care not to mask over the small gap between the fixing point and the fixing plate. This is designed to receive the top coat resin.

When applying the resin top coat make sure that it flows into the gap between the top part and the fixing plate. The IFP-GRP is waterproof with no topcoat - this groove is just to protect and terminate the edge of the topcoat covering in. See Fig 3 below.

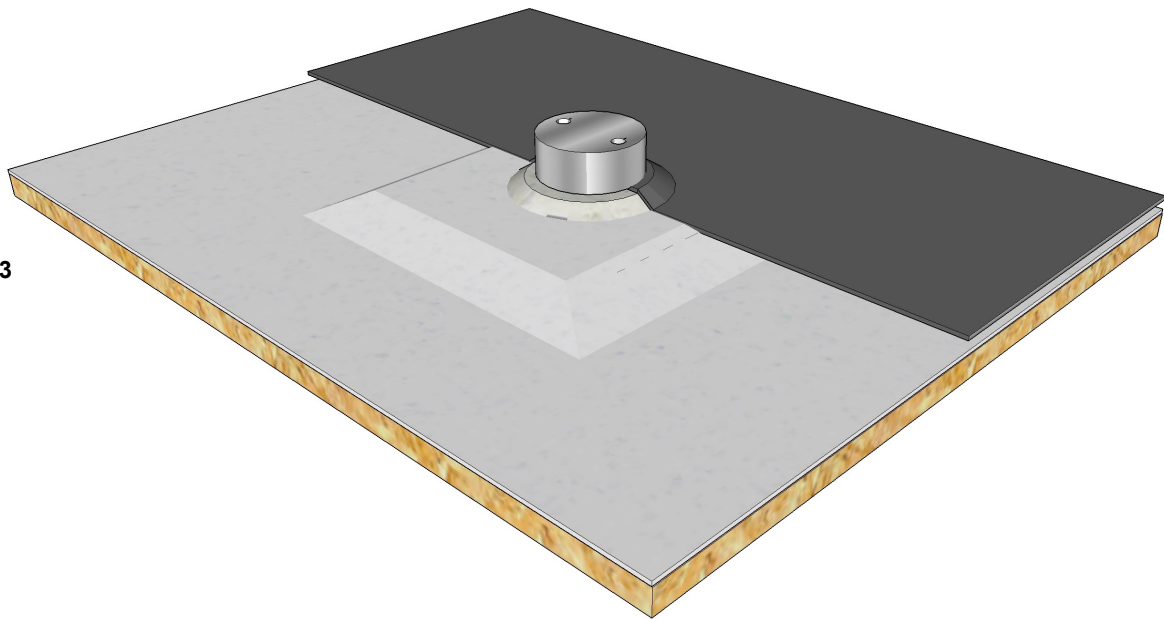

Fig 3

Health & Safety

Ensure that adequate measures are taken to warn pedestrian traffic of possible trip hazards. These measures would include notifying all personnel using the immediate area, the site safety officer and site agent. The warning sign attached should be placed in an appropriate visible location so that it is visible on approach to the roof area in question.



CAUTION

**Trip Hazards on this roof –
proceed with care!**

Place this warning notice in an appropriate position to warn operatives *before* accessing the roof area